



PROMAX® POWER DIRECT VENT

The ProMax Power Direct Vent water heaters have been engineered to maximize efficiency and deliver a greater energy factor (EF).

FEATURES

ENERGY STAR® QUALIFIED

- All models meet the September 2010 ENERGY STAR® EF requirement and may also qualify for local utility and rebate programs
- Dynaclean™ II dip tube optimizes inlet water pressure to minimize cold water regions within the tank. The self-cleaning action also reduces sediment accumulation on the bottom of the tank.
- Hot-surface ignitor is more robust and reliable than standing pilot, and reduces energy consumption
- Built-in heat traps on the water inlet and outlet reduce the amount of heat lost through piping
- 2-inch, thick, "Environmentally-Friendly" foam insulation reduces the amount of heat loss and contributes to overall energy efficiency

BLUE DIAMOND® GLASS COATING

- An A. O. Smith exclusive provides superior corrosion resistance compared to the industry-standard glasslining

POWER DIRECT VENT DESIGN

- Combined horizontal and vertical vent runs up to 180 equivalent feet with 4" diameter venting (ABS, PVC, CPVC and polypropylene)
- Two-pipe sealed combustion system uses outside air, eliminating problems caused by insufficient indoor ventilation
- Reduced NOx emissions comply with air quality management district regulations

USER-FRIENDLY

- State-of-the-art electronic gas control provides more precise temperature control
- LED control light displays operation status and diagnostics information
- Factory-installed T&P and a durable, tamper-resistant brass drain valve are positioned for service accessibility

AVAILABLE IN NATURAL GAS AND PROPANE

6-YEAR LIMITED TANK AND PARTS WARRANTY



Series 200/201





Residential Gas Water Heaters

PROMAX® POWER DIRECT VENT

DIMENSIONS

MODEL NUMBER	SERIES	HEIGHT TO TOP OF BLOWER A	HEIGHT TO TOP OF TANK B	DIAMETER C	OVERALL DEPTH D	HEIGHT TO DRAIN E	HEIGHT TO GAS INLET F	HEIGHT TO T&P G	HEIGHT TO UPPER SIDE CONNECT G	HEIGHT TO LOWER SIDE CONNECT H	SHIPPING WEIGHT LBS
GPD L 40	200	58-1/4	49-1/2	22	29-7/8	11	13-1/4	42-3/8	42-3/8	15-1/4	174
GPD T 50	200	67-1/2	58-3/4	22	29-7/8	11	13-1/4	51-3/4	51-3/4	15-1/4	192
GPD X 50L	200	69	60-1/4	22	29-7/8	11	13-1/4	52-3/4	52-3/4	15-1/4	200
GPD X 75L	200	70-5/8	60-1/2	26	33-7/8	11	13-1/4	53	53	15-1/4	277

All dimensions in inches.

Side connections available on GPD L and GPD T models. Add "L" to the model number, e.g. GPD L-40L.

Side connections are standard on GPD X models.

Natural gas models cited are series 200. Propane models are series 201

All models rated for installation at altitudes up to 10,100 ft.

SPECIFICATIONS

MODEL NUMBER	GALLON CAPACITY	INPUT BTU/H	ENERGY FACTOR	FIRST HOUR RATING USG	RECOVERY 90°F RISE GPH
GPD L 40	40	40,000	0.71	71	45.2
GPD T 50	50	45,000	0.70	93	50.3
GPD X 50L	50	62,000*	0.71	115	72.6
GPD X 75L	75	72,000	0.69	154	82.4

*Propane model has an input of 58,000 Btu/h

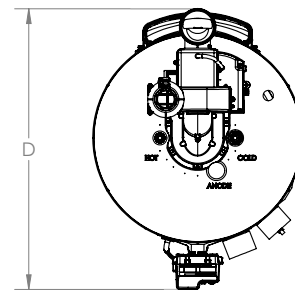

VENT LENGTH

MODEL NUMBER	MAXIMUM VENT LENGTH EQ. FT.		
	Ø2"	Ø3"	Ø4"
GPD L 40	50'	125'	180'
GPD T 50	50'	125'	180'
GPD X 50L	N/A	50'	125'
GPD X 75L	N/A	50'	125'

OPTIONAL VENT KITS

DESCRIPTION	PART NUMBER
2" Vent Kit - Coupling, termination elbows, sound suppressor	330828-000
3" Vent Kit - Coupling, termination elbows, sound suppressor	330851-000
2" Concentric Vent Kit	9008586005
3" Concentric Vent Kit	9006328005
Hi Ambient Kit	9009024015

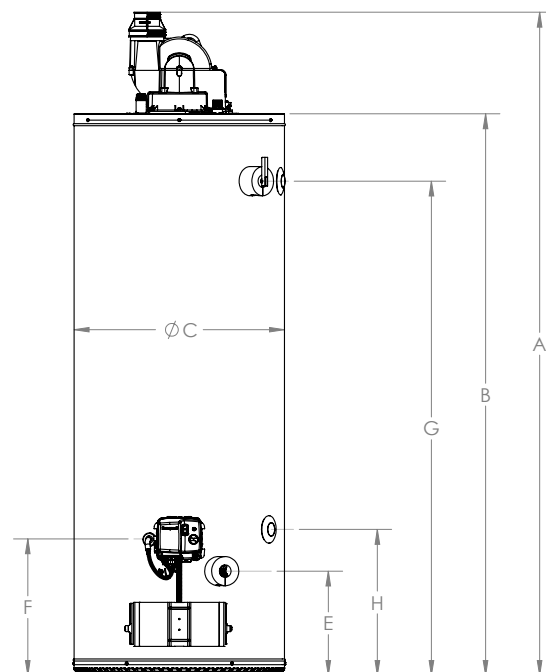

For Technical Information call 1-877-737-2840. A. O. Smith Corporation reserves the right to make product changes or improvements without prior notice.