



GERBER

43-143-W Maxwell® SE

Two Handle Lavatory Faucet



Features:

- Three hole installation
- Washerless cartridges G0097497
- Includes plastic pop-up drain G0097770 with color-matching cap and grey tailpiece; includes pop-up drain GA605007 with color-matching cap and rough brass tailpiece; includes 50/50 pop-up drain GA505020 with color-matching cap and black tailpiececap and rough brass tailpiece; or no drain
- 4" center to center installation range
- Chrome & brushed nickel finish
- 1.5 gpm (5.7 L/min) maximum aerator G0091567 @ 60 psi
- Lead free waterway per NSF/ANSI 372
- Fully ADA compliant
- Limited lifetime warranty

Standards & Certifications:

- ASME A112.18.1M
- NSF/ANSI 372
- IAPMO/cUPC
- ICC/ANSI A117.1
- EPA/Watersense
- MASS Code

Catalog Numbers:

43-143-W	Less drain, Chrome
43-144-W	Plastic Pop-Up, Chrome
43-145-W	Brass Pop-up, Chrome
43-145-W-BN	Brass Pop-up, Brushed Nickel
43-146-W	50/50 Pop-Up, Chrome

Prefixes Available:

None

Suffixes Available:

-W	Washerless
-BN	Brushed Nickel

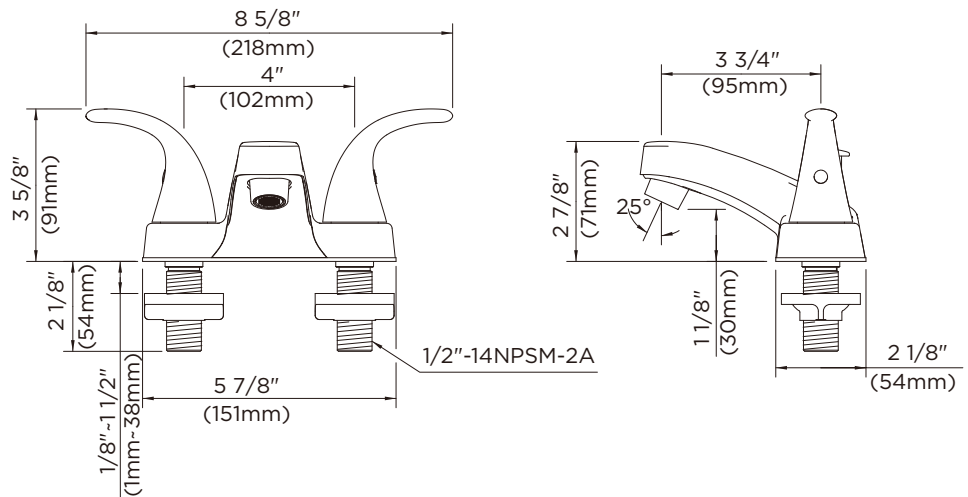
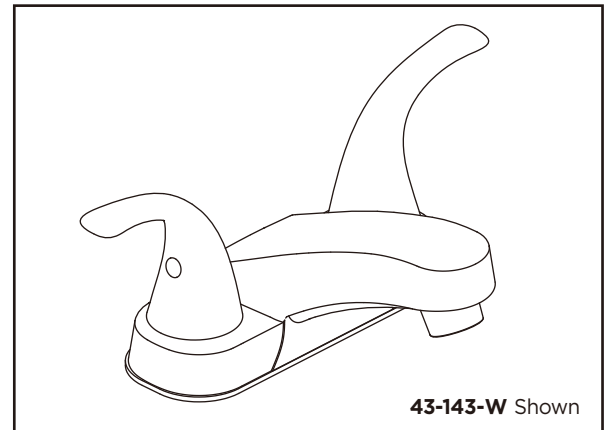

Job Name	
Date	
Model Specified	
Quantity	
Customer	
Contractor	
Architect/engineer	

Gerber Toll Free Technical Support: 888-648-6466
www.gerberonline.com