

## OASIS® VERSAFILTER III KIT

Part number 041253-001

### INSTRUCTIONS TO RETROFIT

VERSAFILLERS PWEBF, PWSBF and AQUA POINTE PWSMEBF, PWSMSBF BOTTLE FILLERS

#### What's Included:

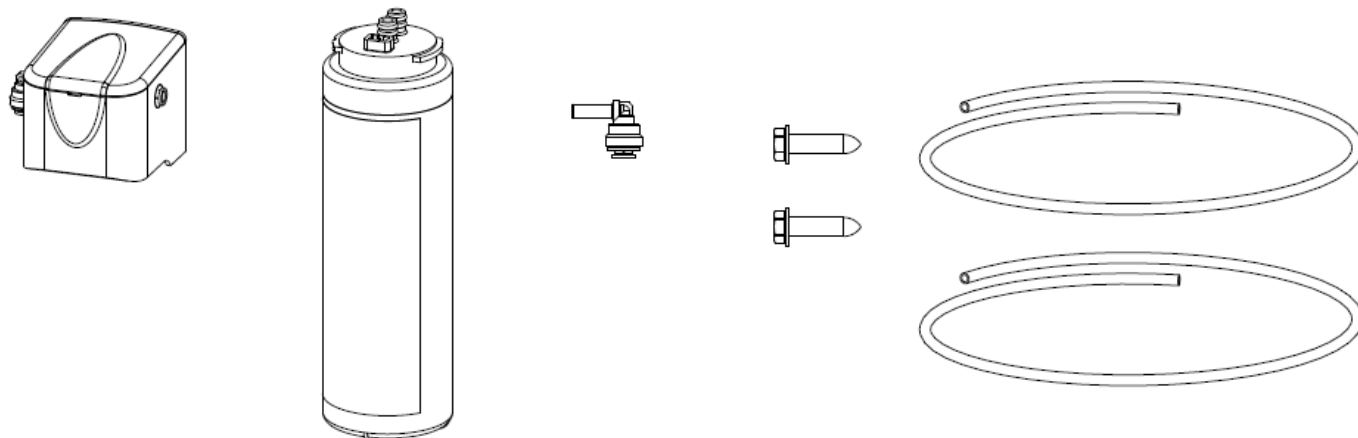

1. Versafilter III Head Assembly with one Quick-Connect Elbow Fitting

2. Versafilter III Cartridge

3. 1/4" OD Quick-Connect Elbow Fitting

4. #8 x 5/8" Long Hex Head Self-Drilling Screw (Qty. 2)

5. 1/4" OD x 38" Long White Plastic Tubing (Qty. 2)

6. Instructions (not shown)

#### Quick-Connect Fittings

1. If you need to cut the plastic tubing, be sure to cut tube ends square and straight. Do not deform the tube (i.e., cause tube to compress its diameter so it is no longer round, or it may result in a water leak at the fitting).
2. Make sure the outer surface of the tube is clear of marks or scratches for a length equal to twice the tube diameter. This allows the "O" ring to seat properly against the tube (See figure below).
3. Avoid sharp changes in direction when routing the tubing. Sharp turns could cause the tubing to kink, which reduces its flow capacity and or stops it completely.
4. Fittings consist of two parts: a body and a collet. (See figure below).
5. To install a tube, push it through the collet until it seats firmly at the bottom of the fitting.
6. To remove a tube, push and hold the collet against the body while pulling the tube out. Pushing the tube into the body before pushing the collet in will aid in the removal of the tube.

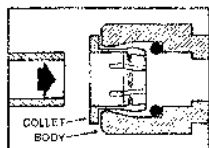

Push tube through Collet into Body

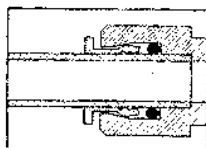

Tube must seat firmly at bottom of fitting

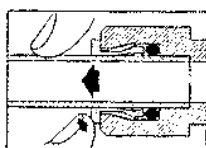

Push Collet against Body to release tube

## Installation Instructions

### SECTION A: For models PWEBF and PWSBF with an Oasis water cooler

#### 1. Water Cooler

- 1.1. Remove the water cooler front access panel and the left side panel. Save screws.
- 1.2. Turn off water supply to cooler.
- 1.3. Actuate bubbler valve on the cooler and actuate the bottle filler sensor on hands-free model to relieve water pressure in the tubing.
- 1.4. Disconnect water cooler and bottle filler power cords from the power supply outlet.

#### 2. Bottle Filler

- 2.1. **For bottle fillers built 2019 and after**, remove two (2) T15 drive Torx head screws securing Bottle Filler Cabinet to Frame (one each side of the bottle filler cabinet). Tip the Bottle Filler Cabinet forward on the Water Cooler. Attach the Tether to hold Bottle Filler in place while performing **Step 2.3 below**.
- 2.2. **For bottle fillers built prior 2019 (referenced as "OLDER FRAME")**, remove the two (2) T15 Torx head screws securing top panel to the bottle filler and remove top. Remove four (4) T15 drive Torx head screws securing the Bottle Filler Cabinet to Frame.
- 2.3. **Hands-Free Bottle Filler:** Carefully disconnect the water tube from the quick-connect inlet fitting of solenoid valve and disconnect the power cord if applicable from the power supply located inside bottle filler cabinet. Disconnect the Tether if applicable from the frame and set the cabinet assembly aside. See **"Quick-Connecting Fittings"** instructions above for making quick-connect fitting connections.
- 2.4. **Mechanical Bottle Filler:** Carefully disconnect the water tube from the inlet quick-connect elbow fitting on the cartridge valve noted as "IN" and set cabinet assembly aside. See **"Quick-Connecting Fittings"** instructions above for making quick-connect fitting connections.

#### 3. Installing Versafilter III Filter Head to Bottle Filler Frame

- 3.1. Remove top cover of the Versafilter III Filter Head and set aside. Install Filter Head to location shown in **Diagrams 1 & 2**. Secure with two (2) #8 Self-Drilling Hex Head Screws provided. For older frames **See Diagrams 1 & 2 OLDER FRAME**.
- 3.2. Assemble one (1) quick-connect Elbow Fitting provided to the outlet (left side) of the Filter Head shown in **Diagram 2**. The quick-connect Elbow Fitting on the inlet (left side) is pre-installed. Re-install Filter Head Cover.

#### 4. Installing the Versafilter III Filter Cartridge to Filter Head

- 4.1. Install Filter Cartridge per the directions noted on the filter cartridge. Replacement cartridges should be obtained by contacting an Oasis distributor.

#### 5. Bottle Filler & Water Cooler

- 5.1. Remove the white ¼" OD tube connected at the 3/8" OD x ¼" OD quick-connect reducing union fitting at the cooler water supply shut-off valve and at the quick-connect elbow fitting on the left side (inlet) of the insulated cooling tank and discard.
- 5.2. Insert one white ¼" OD x 38" Long Plastic Tube provided into the Filter Head **INLET** (left side) quick-connect Elbow Fitting. Feed tube through hole in frame and hole in water cooler top. Insert the other end of the Tube into the 3/8" OD x ¼" OD quick-connect reducing union fitting at water supply shut-off valve.

#### 6. Flushing the Versafilter III Filter Cartridge

- 6.1. Insert second white ¼" OD x 38" long plastic tube provided into the Filter Head **OUTLET** (right side) quick-connect elbow fitting.
- 6.2. Route the other end of the tube to the Water Cooler **DRAIN**.
- 6.3. Turn on water supply to Water Cooler. Check for leaks. Run water at a minimum for 2 minutes and until water is clear. **Turn off water supply. Flushing is complete.**

6.4. Now feed the tube at the Filter Head **OUTLET** (right side) through hole in Bottle Filler Frame and the hole in the Water Cooler top. Insert the other end of the tube into the quick-connect Elbow Fitting on the left side (inlet) of the insulated cooling tank.

## **7. Bottle Filler**

7.1. Return bottle filler cabinet assembly to the gasket on the Water Cooler Top near the Bottle Filler Frame, angling it and reattaching the tether to the bottle filler frame if applicable. Re-connect the water tube and power supply cord disconnected in **Step 2.3 or 2.4**. Tip the bottle filler cabinet back into place against frame.

## **8. Water Cooler & Bottle Filler**

8.1. Turn on water supply to cooler. Plug-in water cooler and bottle filler power cords in power supply outlet.  
8.2. Actuate bubbler valve on the cooler and actuate the bottle filler sensor on hands-free model or bottle filler pushbutton on mechanical model to remove air bubbles in water lines. Check for leaks.

## **9. Bottle Filler**

9.1. Re-install bottle filler cabinet assembly to frame with the two (2) T15 Torx screws removed in **Step 2.1** and six (6) T15 Torx screws removed in **Step 2.2**.

## **10. Water Cooler**

10.1. Replace the removed panel(s) on the Water Cooler using screws saved in **Step 1.1**.

# **SECTION B: For models PWSMEBF and PWSMSBF**

## **1. Turn off water supply to bottle filler.**

1.1. Actuate the bottle filler sensor on hands-free model or push button on mechanical model to relieve water pressure in the tubing.

2. **See Section A, Step 2.** Removing Torx screws.

3. **See Section A, Step 3.** Installing Versafilter III Filter Head to Bottle Filler Frame.

4. **See Section A, Step 4.** Installing Versafilter III Filter Cartridge to Filter Head.

## **5. Bottle Filler**

5.1. Remove the white ¼" OD tube connected at the 3/8" OD x ¼" OD quick-connect reducing union fitting at the bottle filler water supply shut-off valve and discard.

5.2. Insert one (1) white ¼" OD x Long Plastic Tube provided into the Filter Head **INLET** (left side) quick-connect elbow fitting. Feed tube through hole in frame. Insert other end of the tube into the 3/8" OD x ¼" OD quick-connect reducing union fitting at water supply shut-off valve.

## **6. Flushing the Versafilter III Filter Cartridge.**

6.1. Insert second white tube ¼" OD long plastic tube provided into the Filter Head **OUTLET** (right side) quick-connect elbow fitting. Place the other end of tube into an overflow container.

6.2. Run water at a minimum for 2 minutes and until water is clear.

6.3. **Turn off water supply.** Flushing is complete.

7. **Hands-Free Bottle Filler:** Place bottle filler cabinet assembly near bottle filler frame, insert the other end from Step 6.1 into the quick-connect inlet of solenoid valve and re-connect the power cord to the power supply located inside bottle filler cabinet.

8. **Mechanical Bottle Filler:** Place bottle filler cabinet assembly near bottle filler frame, insert the other end from **Step 6.1** into the quick-connect elbow fitting on the inlet of the cartridge valve noted "IN". It will be necessary to cut excess tubing before making the connection.

9. **Turn on water supply to cooler.** Plug-in bottle filler power cord if it was disconnected. Re-connect trap to drain tailpiece. Check for leaks.

10. **Bottle Filler:** Re-install bottle filler cabinet assembly to frame with the two (2) T15 Torx screws removed in **Section A, Step 2.1** and six (6) T15 Torx screws removed in **Section A, Step 2.2**.

11. Actuate bottle filler sensor on hands-free model or push button on mechanical model to remove air from water lines. Check for leaks.

## Models Built 2019 and After

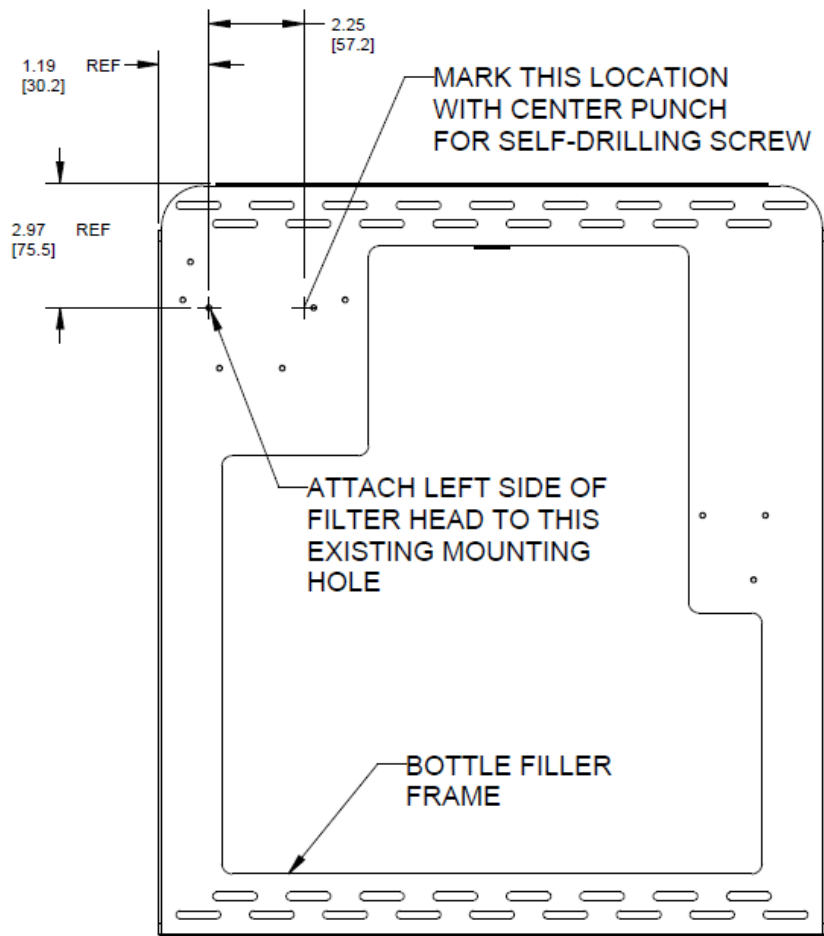

**DIAGRAM 1**  
**STEP 3.1**

**SEE NEXT PAGE FOR**  
**OLDER FRAME**

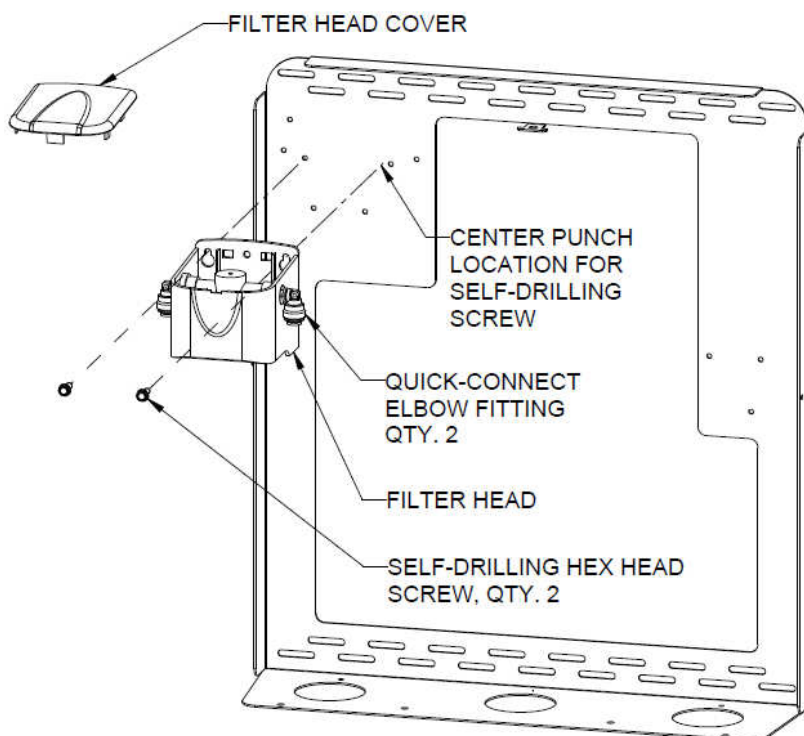

**DIAGRAM 2**  
**STEP 3.1 & 3.2**

**Models Built Before 2019**

**OLDER FRAME**

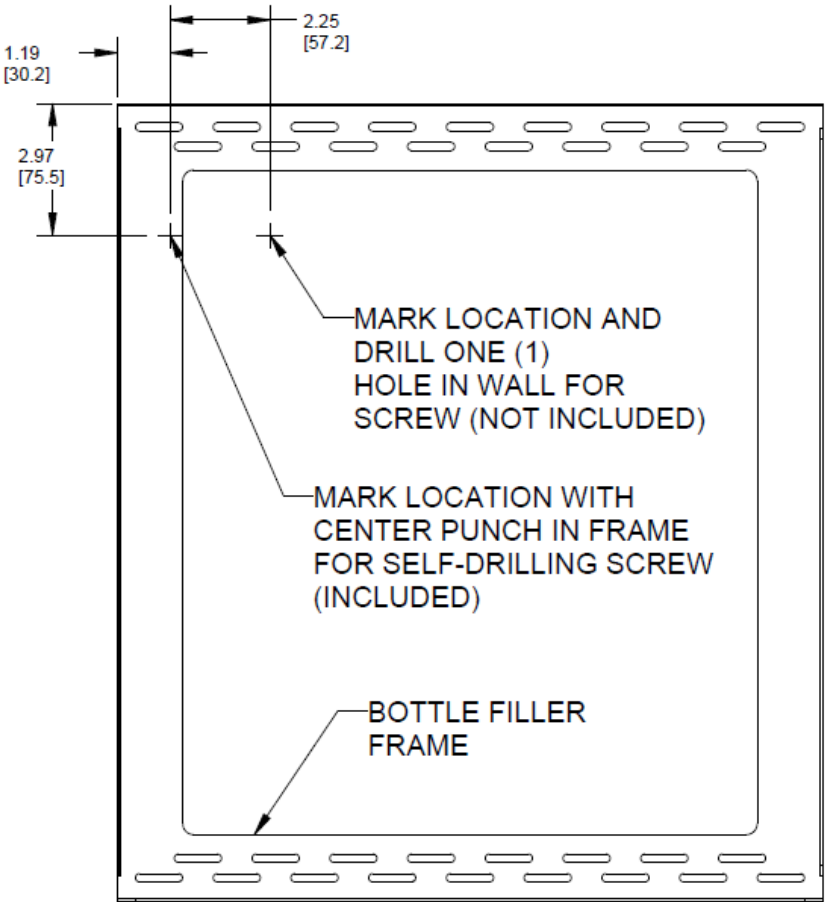

**DIAGRAM 1**  
**STEP 3.1**

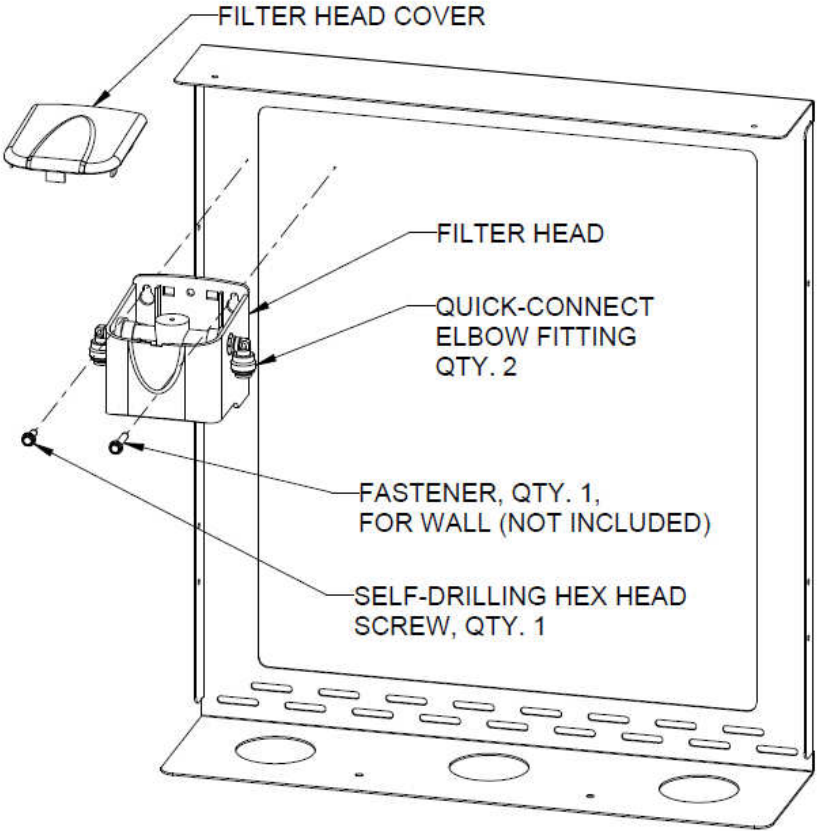

**SECURE FILTER HEAD ASSEMBLY AT THE LOCATION SHOWN IN FRAME WITH ONE (1) #8 SCREW PROVIDED AND ONE (1) FASTENER IN WALL NOT PROVIDED**

**DIAGRAM 1**  
**STEP 3.1 & 3.2**



OASIS INTERNATIONAL

222 East Campus View Blvd. • Columbus, OH 43235 U.S.A.

1-800-950-3226

[www.oasiscoolers.com](http://www.oasiscoolers.com)

OASIS is a registered trademark of LVD Acquisition, LLC dba Oasis International

© 2021 LVD Acquisition, LLC  
030099-650, Rev. A, 12/2021