

Features

- KOHLER cast iron
- Acid-resistant enamel finish
- Self-rimming
- Single compartment
- 3-hole
- 25" (63.5 cm) x 22" (55.9 cm)

Codes/Standards Applicable

Specified model meets or exceeds the following:

- ASME A112.19.1M
- IAPMO/UPC
- CSA B45

SELF-RIMMING UTILITY SINK K-6749

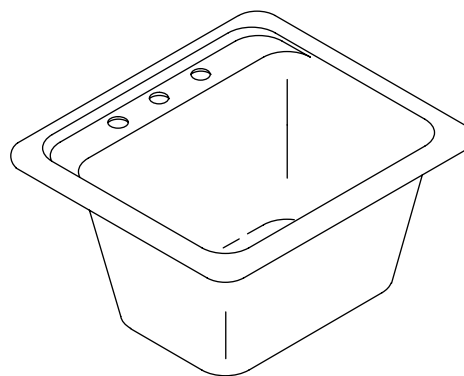

Colors/Finishes

- 0: White
- Other: Refer to Price Book for additional colors/finishes

Accessories:

- CP: Polished Chrome

Specified Model

| Model | Description | Colors/Finishes | |
|--------------------------------|------------------------------|-----------------------------|-------------------------------------|
| K-6749-3 | 3-hole sink | <input type="checkbox"/> 0 | <input type="checkbox"/> Other_____ |
| Recommended Accessories | | | |
| K-9000 | P-Trap | <input type="checkbox"/> CP | |
| Optional Accessories | | | |
| K-8820 | Sink strainer with tailpiece | <input type="checkbox"/> CP | |

Product Specification

The utility sink shall be made of cast iron with acid-resistant enamel finish. Sink shall be self-rimming with a single compartment. Sink shall be 3-hole. Sink shall be 25" (63.5 cm) in length and 22" (55.9 cm) in width. Sink shall be Kohler Model K-6749-3-_____.

GLEN FALLS™

Technical Information

| | |
|---|-------------------------------|
| Fixture*: | |
| Basin area | 22" (55.9 cm) x 15" (38.1 cm) |
| Water depth | 12-1/2" (31.8 cm) |
| Water capacity | 14 gal (53 L) |
| Drain hole | 2-1/8" (5.4 cm) D. |
| Faucet holes | 1-3/8" (3.5 cm) D. |
| * Approximate measurements for comparison only. | |

Installation Notes

Install this product according to the installation guide.

Cutout is 23-1/2" (59.7 cm) by 20-1/2" (52.1 cm) with 1" (2.5 cm) radius corners.

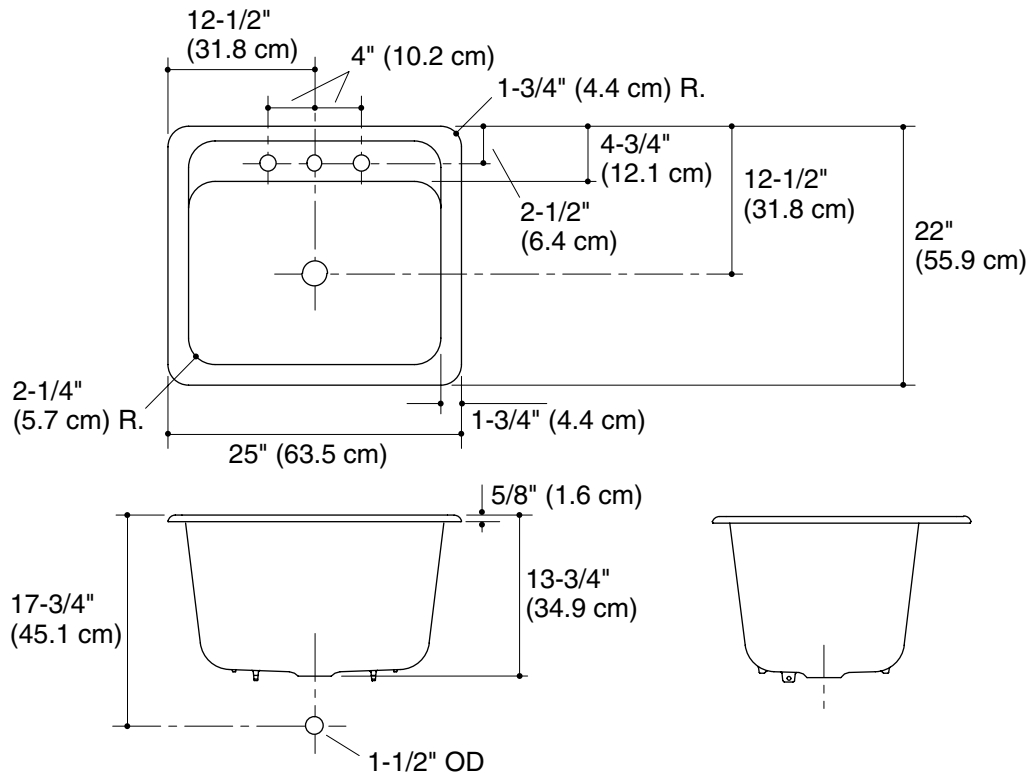

Product Diagram

GLEN FALLS™ SELF-RIMMING UTILITY SINK

Page 2 of 2
112465-4-BC

THE BOLD LOOK
OF **KOHLER**®