

**1 BEFORE INSTALLATION**

**HOT WATER SUPPLY TEMPERATURE.** Maximum inlet hot water temperature is 185°F (85°C) and the minimum inlet cold water temperature is 41°F (5°C). The recommended hot water inlet temperature is 149°F (65°C). The minimum temperature difference between the hot inlet water temperature and the mixed tempered water temperature is 50°F (10°C).

**OPERATING PRESSURE.** The recommended maximum inlet water pressure is 75 PSI (5.1 bar). Minimum water inlet pressure is 15 PSI (1.0 bar). Piping should be installed properly to maintain a balance between Hot and Cold inlet operating pressure to maintain maximum efficiency and consistent mixed water temperature. When water pressure exceeds 75 PSI, a pressure reducing valve needs to be installed upstream of the mixer. Typical average water pressure is 45 PSI / 3 Bar (figure 2)

**INSTALLATION INFORMATION**

See the installation depth guide on the plastic mud guard for minimum and maximum wall depth installation (Figure 3). The mixer is furnished with a maximum temperature limit stop set at 109.4°F (43°C). Mixer inlet and outlet ports are ¾" NPT. The bottom outlet may be used for a bath spout or plugged with a standard ¾" NPT pipe plug. A separate shut off valve must be used in conjunction to control on/off function and flow control. The valve TMV07OMBG does not have an integral shut off valve. Separate shut off valve(s) need to be used. A temperature variation will occur if water is dually supplied by both the top and bottom port at the same time.

**PLUMBING RECOMMENDATIONS**

- Large runs of pipe work will cause frictional loss of pressure.
- Flush all piping thoroughly before installing the valves to prevent clogging of filter screens.
- Ensure adequate supply of both hot and cold water can be maintained.

**BUILDING CODE COMPLIANCE.** The mixing valve complies with ANSI/NSF61 standard and should be installed in compliance of local building codes.

BAR	gpm
0.1	1.7
0.2	2.6
0.3	3.3
0.4	4.0
0.5	4.5
1.0	6.7
1.5	8.3
2.0	9.6
2.5	10.7
3.0	11.7
3.5	12.5
4.0	13.4
4.5	14.3
5.0	15.1

*Figure 2***Hot Water Inlet Temperature:**

140 / 149°F (60 / 65°C)

**Cold Water Outlet Temperature:**

50 / 59°F (10 / 15°C)

**Mixed Pre-Set Outlet Temperature:**

100.4°F (38°C)

### 2 INSTALL VALVE INTO WALL

Use the installation depth guide on the plastic mud guard for minimum and maximum wall depth installation.

Keep plastic guard on until after tile has been installed.

If extensions are needed use the following item codes to order extensions. These allow for a maximum length of 1 1/2."

DIVTREXTUNF: Diverter extension  
SOVLVEXTUNF: Shut off extension  
TMVEXT(XXX): Thermostat extension  
XXX: PCH / PNI / SNI



fig. 3a

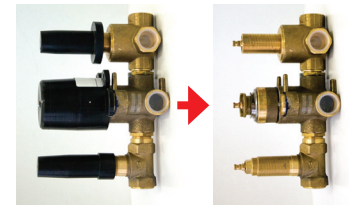

fig. 3b  
WITH PLASTIC  
GUARD ON

fig. 3c  
PLASTIC GUARD  
REMOVED

### 3 INSTALL RING AND PLATE FOR THERMOSTATIC HANDLE

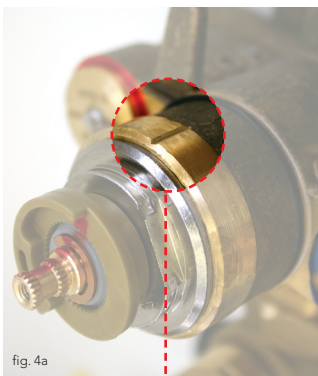

fig. 4a

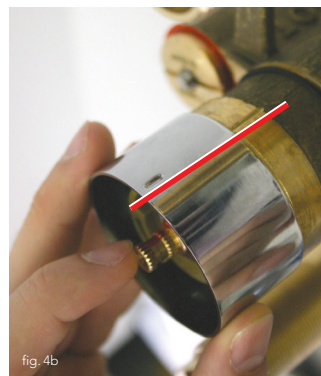

fig. 4b

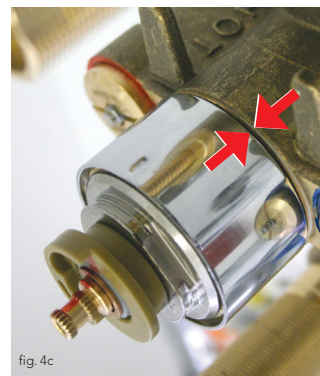

fig. 4c

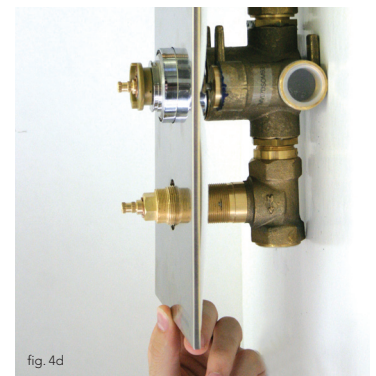

fig. 4d

Notice the groove on the thermostatic mixer valve.

Slide ring (TMVTROMBGXX) onto thermostatic mixer valve. Make sure notch on ring aligns into the groove on the thermostatic mixer valve.

Make sure ring is **COMPLETELY FLUSH** to the valve to ensure proper installation. If not reverse the ring as shown.

Place plate (DVC379RE3HXX) onto thermostatic mixer valve, flush to wall.

### 4 INSTALL THERMOSTATIC ADAPTER AND HANDLE

The temperature limit ring (figure 5a) is placed by the manufacturer for safety/comfort reasons. It can be removed on client's request by the installer. If removed or replaced the installer must recalibrate and realign for accurate temperature.

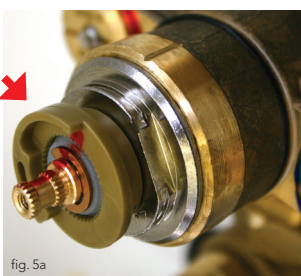

fig. 5a

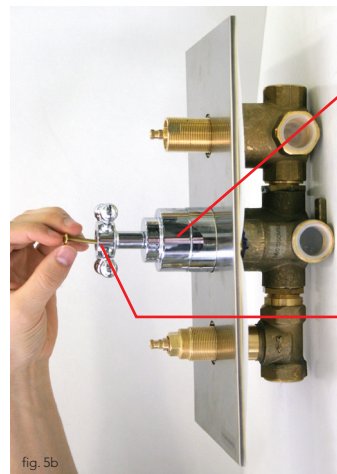

fig. 5b



fig. 5c



fig. 5d

1. Place handle adapter (OMBG33120XX) (figure 5c) onto thermostatic mixer valve.

2. Depending on handle, set screw (figure 5c) may be needed to secure adapter onto thermostatic mixer. In this instance, use the screw (figure 5d) accompanying the handle to secure both handle and adapter to thermostatic mixer.

3. Place handle (figure 5d) onto handle adapter.

4. Use the accompanying brass screw to tighten with a screw driver.

5. Twist index cap onto handle.



### 5 INSTALL DIVERTER AND/OR SHUT OFF ADAPTER AND HANDLES

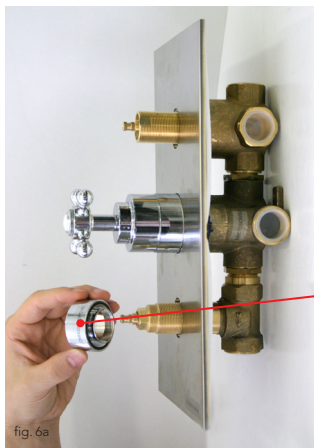

1. Place round handle base (OMBG30120XXA) with **o-ring faced down** onto plate.



2. Depending on handle, the set screw (figure 6b) may be needed to secure adapter onto shut off or diverter. Hold onto these parts if they are needed.

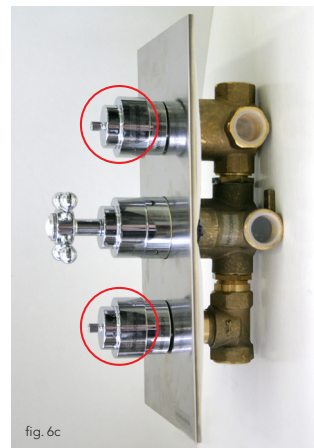

3. Place handle adapter (OMBG30120XXB) over round handle base (OMBG30120XXA).
4. Repeat steps 1-3 for the diverter or other shut off handle.

### 6 INSTALL DIVERTER AND/OR SHUT OFF HANDLES

1. Screw handle (YYY33120XX) into the round handle base (OMBG30120XX).

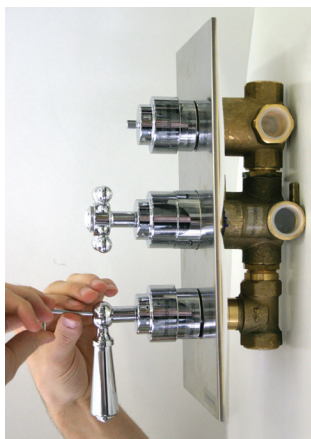
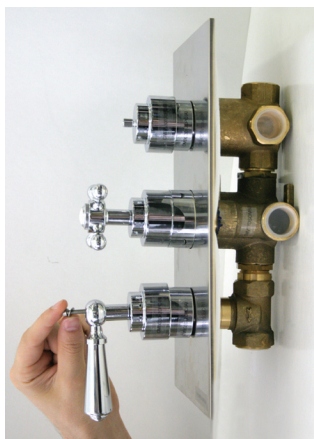

2. Use the allen key to tighten washer and screw into the handle and adapter.
3. Twist the index button back onto handle.
4. Repeat steps 1-4 for the diverter or other shut off handle.

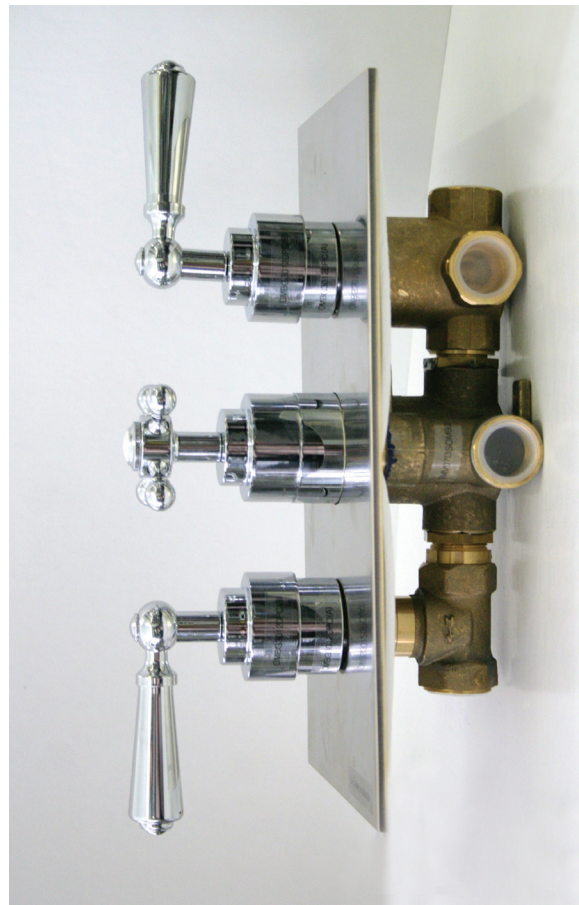

00-387NR-000

00-387NDR-000

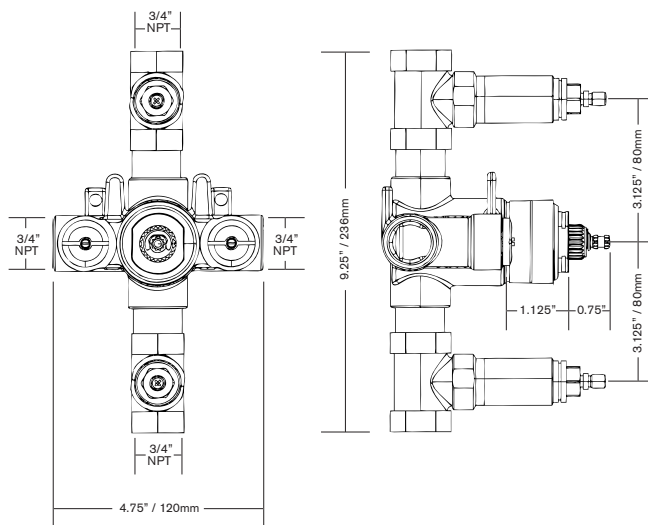
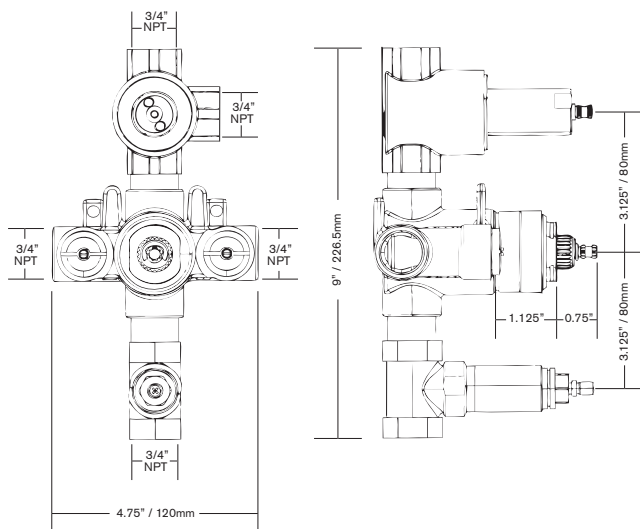

## Parts Explosion for Thermostatic Mixer Less Handles

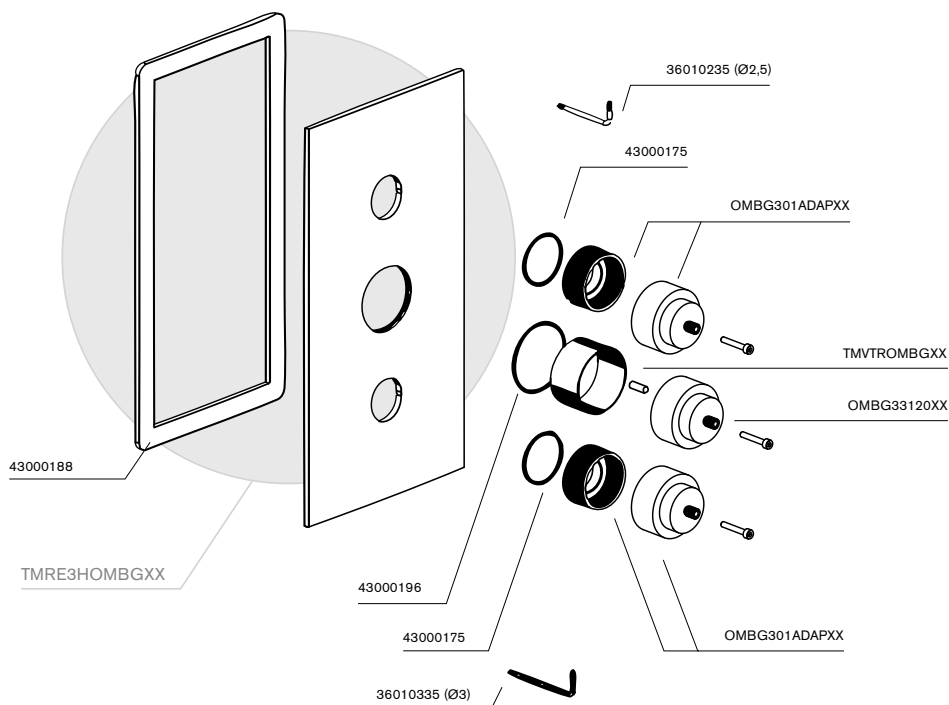

## Extensions (sold separately)

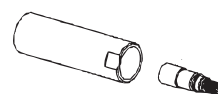

DIVTREXTUNF  
DIVERTER EXTENSION

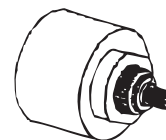

TMVEXT(PCH) (PNI) (SNI)  
THERMOSTAT EXTENSION



SHUT OFF EXTENSION  
SOVLVEXTUNF

MAXIMUM LENGTH OF 1 1/2"