

GRIFFIN **61" CAST IRON** **SLIPPER TUB**

Cat. No.
 CTSN60



L: 61-1/4"
 W: 30-1/2"
 H: 21-1/2" - 29-1/8" (from floor to top of tub)

Water Depth: 16-1/8" at to top of tub
 Water depth: 13-3/8" to over-flow

The following is recommended for
 CTSN60 tubs without deck holes:

- Faucet: part #4602, 4604 or 7082
- Rigid, freestanding supplies: part #4502
- Leg tub drain: part #5599

Gallon Capacity: 43
 Shipping Weight: 500 lbs.
 Empty Weight: 300 lbs.
 Filled Weight: 679 lbs.

Features:

- Inside finish is white enamel
- Cast Iron ball and claw feet
- Tub exterior is white (epoxy)
- No faucet holes
- Non-skid strips
- ICC-ES certified
- UPC certified
- Continuous rolled rim
- Ball and claw feet available in 9 finishes
- Feet are attached and leveled before shipment
- Tub is thoroughly inspected before shipment



Foot Finishes:

UF Unfinished
 BL Painted Black
 BQ Painted Bisque
 PB Polished Brass



CP Polished Chrome
 WH Painted White
 PN Polished Nickel
 SN Brushed Nickel
 ORB Oil Rubbed Bronze

Custom Colors Available (inside of tub is always white enamel):
 Painted bathtubs are considered "special order" and are not returnable
 \$160 Bisque or Black \$250 Designer Color

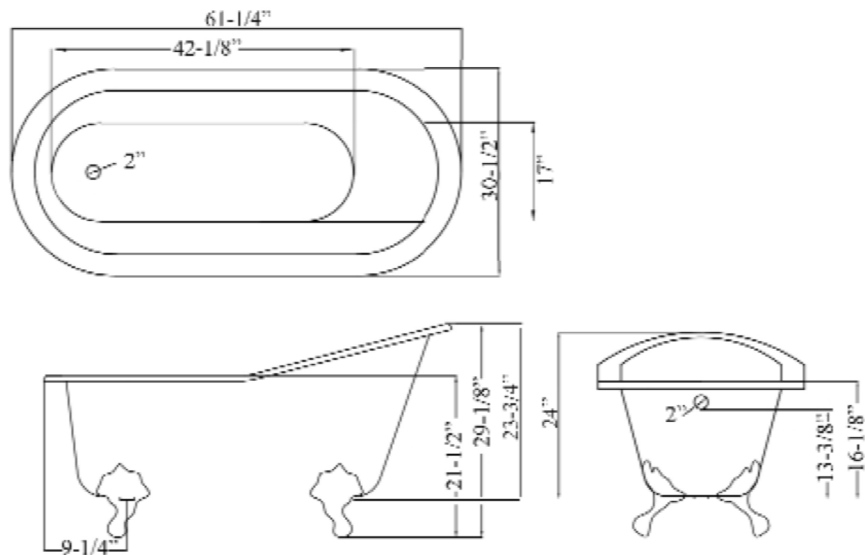

Dimensions of fixture are nominal and may vary within the range of tolerances established by ANSI Standard A112.19.1M. Dimensions and specifications subject to change without notice.