

Vero Furniture washbasin # 0329850000 / 0329850030

| < 33 1/2" Inch > |

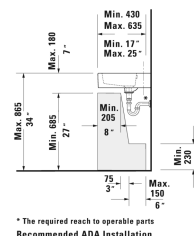
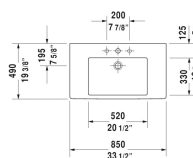
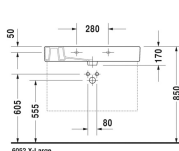
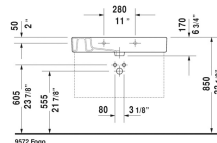
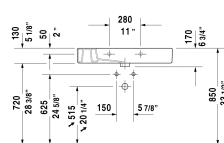

* The required reach to operable parts
Recommended ADA Installation

| Furniture washbasin | Dimension | Weight | Order number |
|--|------------------------|--------|--------------|
| with faucet deck, underside fully glazed, wall-mounted, hardware included, cUPC® listed*, 33 1/2" Inch | | | |
| Colors | | | |
| 00 White | | | |
| Variant | | | |
| ● with overflow | 33 1/2" x 19 1/4" Inch | 56 lb | 0329850000 |
| ●●● with overflow | 33 1/2" x 19 1/4" Inch | 56 lb | 0329850030 |
| Infobox | | | |
| * Complies with following standards: ASME A112.19.2/CSA B45.1, Washbasin is not ADA compliant in combination with pedestal, siphon cover or metal console | | | |
| Sanitary ceramics with the special WonderGliss surface finish will remain clean and attractive-looking for a long time to come. When ordering WonderGliss please add a "1" as eleventh digit to the model number. | | | |
| Towel rail square tube 1/2", Chrome | 31 7/8" Inch | 1 lb | 003036 |
| Metal console height adjustable +2", for furniture washbasin # 032985 | | 7.1 lb | 003071 |
| Space-saving siphon | 1 1/4" Inch | 0.9 lb | 005076 |
| Design Siphon | | 3.3 lb | 005036 |

All drawings contain the necessary measurements which are subject to standard tolerances. They are stated in inch & mm and are non-binding. Exact measurements, in particular for customized installation scenarios, can only be taken from the finished ceramic piece.