

Bacino Vessel Sink # 0325420000

| < Ø 16 1/2 " > |

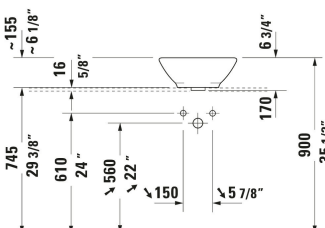
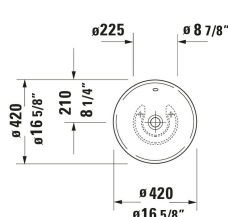

Vessel Sink	Dimension	Weight	Order number
Round, Includes faucet deck: No, Overflow: Yes, Includes overflow clip, 16 1/2 ", cUPC listed: Yes			
Colors			
00 White			
Variant			
⊗ White High Gloss, Number of basins: 1 Middle		15.432 lb	0325420000
Infobox			
Not available in Wondergliss			
Suitable products			
Vanity Cabinet Number of drawers: 1, Includes vanity top: Yes, Faucet holes possible, Handle, Slow close, Lay-in compartment Optional, 31 1/2 x 21 5/8 "	31 1/2 x 21 5/8 "		DE4947
Vanity Cabinet Number of drawers: 1, Includes vanity top: Yes, Faucet holes possible, Handle, Slow close, Lay-in compartment Optional, 39 3/8 x 21 5/8 "	39 3/8 x 21 5/8 "		DE4948
Vanity Cabinet Number of drawers: 1, Includes vanity top: Yes, Faucet holes possible, Handle, Slow close, Lay-in compartment Optional, 47 1/4 x 21 5/8 "	47 1/4 x 21 5/8 "		DE4949
Vanity Cabinet Number of drawers: 1, Number of drawers: 1, Includes vanity top: Yes, Faucet holes possible, Handle, Siphon cut-out: Yes, Panel: Yes, Slow close, Lay-in compartment Optional, 31 1/2 x 21 5/8 "	31 1/2 x 21 5/8 "		DE4967
Vanity Cabinet Number of drawers: 1, Number of drawers: 1, Includes vanity top: Yes, Faucet holes possible, Handle, Siphon cut-out: Yes, Panel: Yes, Slow close, Lay-in compartment Optional, 39 3/8 x 21 5/8 "	39 3/8 x 21 5/8 "		DE4968
Vanity Cabinet Number of drawers: 1, Number of drawers: 1, Includes vanity top: Yes, Faucet holes possible, Handle, Siphon cut-out: Yes, Panel: Yes, Slow close, Lay-in compartment Optional, 47 1/4 x 21 5/8 "	47 1/4 x 21 5/8 "		DE4969

All drawings contain the necessary measurements which are subject to standard tolerances. They are stated in inch & mm and are non-

Bacino Vessel Sink # 0325420000

| < Ø 16 1/2 " > |

binding. Exact measurements, in particular for customized installation scenarios, can only be taken from the finished ceramic piece.