

D-Code One Piece Toilet # 011301..01 / 011301..82 / 011301..82

| < 15 1/2 " > |

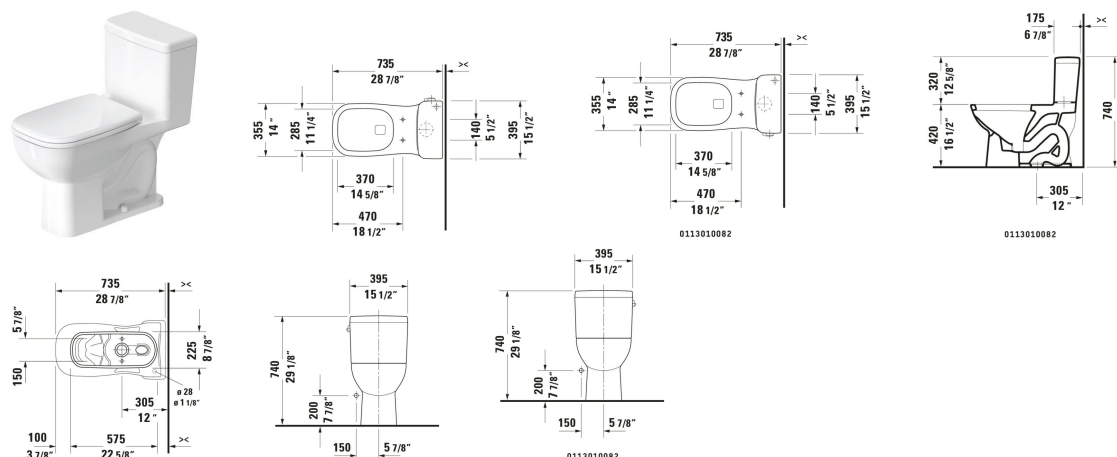

| One Piece Toilet | Dimension | Weight | Order number |
|---|-------------------|-----------|--------------|
| 28 7/8 ", elongated, Flush water quantity: 1.28 gal, Siphonic, Flushing rim: Closed, Outlet: vertical, Rough-in: 12 ", ADA: Yes, cUPC listed: Yes | | | |
| | | | |
| Colors | | | |
| 00 White 20 HygieneGlaze (an antibacterial ceramic glaze that provides almost indefinite effectiveness) | | | |
| | | | |
| Variant | | | |
| White High Gloss, Single Flush, Trip lever placement: Left, WaterSense: Yes | | 87.016 lb | 011301..01 |
| White High Gloss, Single Flush, Trip lever placement: Right, WaterSense: Yes | | 86.862 lb | 011301..82 |
| White High Gloss, HygieneGlaze, Single Flush, Trip lever placement: Right, WaterSense: Yes | | 86.862 lb | 011301..82 |
| | | | |
| Suitable products | | | |
| Toilet Seat Slow close: No, Hinge material: Stainless Steel, elongated, 14 1/8 x 18 3/4 " | 14 1/8 x 18 3/4 " | | 006741 |
| Toilet Seat Slow close: Yes, Removable Seat, Hinge material: Stainless Steel, elongated, 14 1/4 x 18 7/8 " | 14 1/4 x 18 7/8 " | | 006209 |
| One Piece Toilet , 15 1/2 x 28 7/8 " | 15 1/2 x 28 7/8 " | | D40059 |

All drawings contain the necessary measurements which are subject to standard tolerances. They are stated in inch & mm and are non-binding. Exact measurements, in particular for customized installation scenarios, can only be taken from the finished ceramic piece.