

MT744-2

ROUND STYLE LAVATORY DRAIN WITH STATIONARY DOME WITHOUT OVERFLOW

SPECIFICATION SHEET

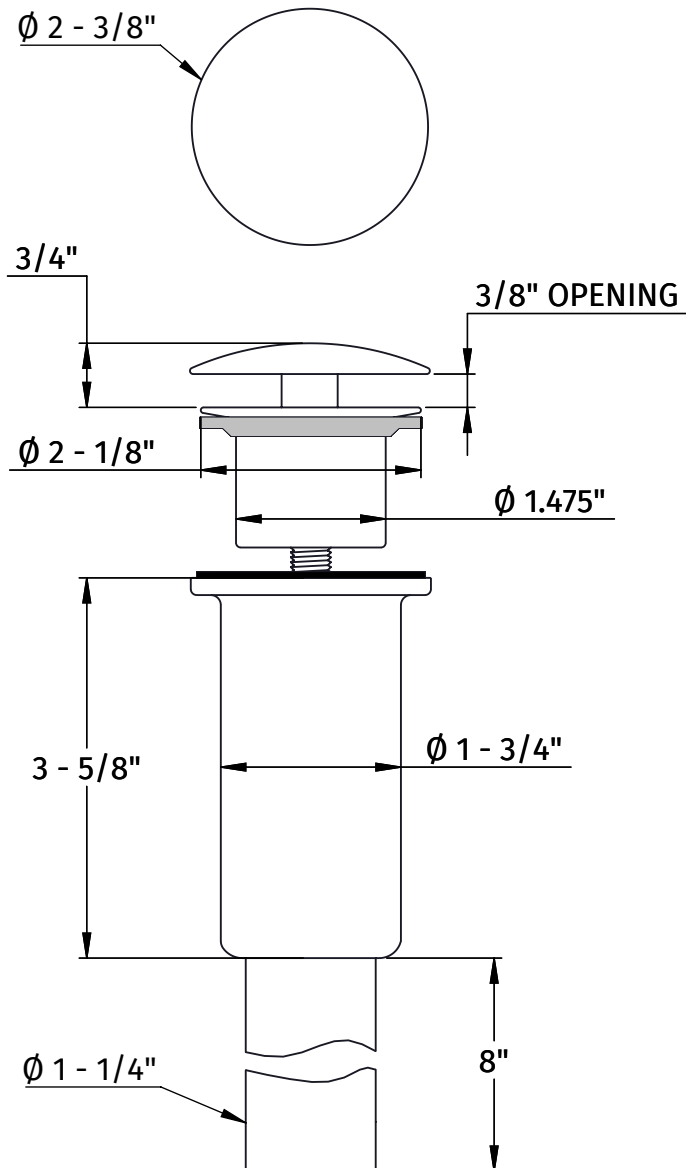

- FOR USE WITH $\phi 1 - 1/2"$ DRAIN OPENING
- INTENDED FOR SINKS AND VESSELS WITHOUT OVERFLOW UP TO $2 - 1/4"$ THICK (NOT SUITABLE FOR COUNTERTOP INSTALLATION)
- $\phi 1 - 1/4"$ TAILPIECE IS REMOVABLE
- ENTIRE DRAIN AND TAILPIECE ARE FINISHED FOR EXPOSED APPLICATIONS
- SUITABLE FOR THIN STAINLESS-STEEL SINKS
- DOES NOT SEAL WATER