



The Davinci Collection

AF Design Lab

Gotham
3-Hole Deck Mounted Lavatory Faucet

GAN-H20-100-5-G-*
Specification

Product Specifications

Series	Gotham
Spout	GAN-5 (Gansevoort 5")
Handle	H20 (Coupe) H20-301 Handle Assembly Includes Components Listed Below
Mounting	(3) Holes @ Ø1-3/8" (35mm)
Features	Drain Included Zero-Lead Brass Ceramic Disc Cartridge 1.2 gpm

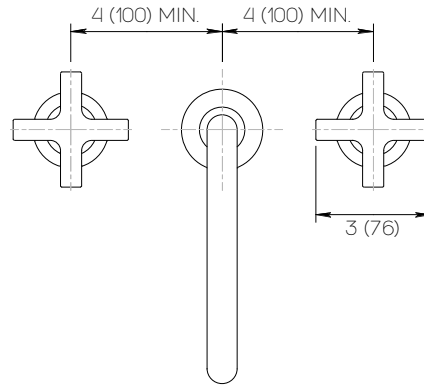

Handle

Coupe Cross COU-301-HDL-*

Handle Base

Groove HI4-301-BASE-G-*

*Finish

For a selection of available standard finishes, please contact your AF Account Manager, or consult www.davincibath.com. Custom finishes upon request.

Applicable Codes & Standards

Specified model meets or exceeds the following:

- ASME A112.18.1/CSA B125.1
- US Federal and State material regulations.
- EPA WaterSense®

Important

Dimensions are nominal and may vary within the range of tolerances established by ANSI Standard A112.18.1. These measurements are subject to change or cancellation. No responsibility is assumed for use of superseded or voided pages.

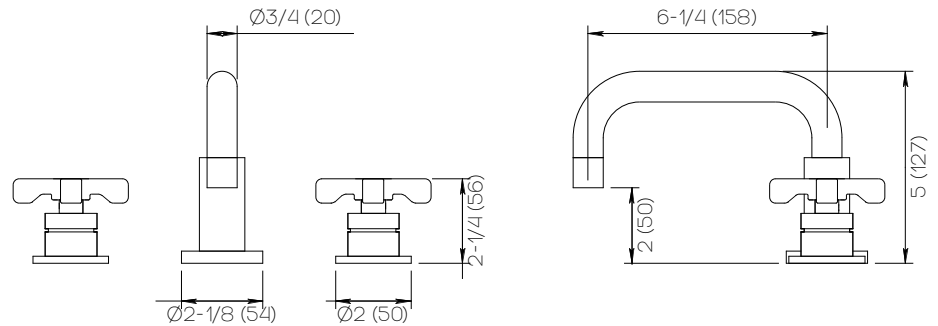

Dimensions Inches (mm)

