

SA0102.01 SPECIFICATIONS

halo blu·stone™ countertop basin

FEATURES:

- Above-the-counter modern design with integral slot overflow
- Made of blu·stone™ providing the look and feel of natural stone
- Matching blu·stone™ waste cover included
- Stronger and more durable than ceramic
- Non-porous, stain resistant surface that does not require sealing
- Does not promote bacteria, mold or fungi

SPECIFICATIONS:

Drain hole:	Ø1¾" (45mm)*
Size:	23½" x 17¾" (600mm x 450mm)*
Height:	5¾" (145mm)
Warranty:	Five Year Warranty (Residential use) One Year Warranty (Commercial use)
Material:	blu·stone™
Shipping Weight:	37.5 lbs (17 kg)
Shipping Dimensions:	(LWH) 25½" x 19¾" x 7¾" (650mm x 500mm x 200mm)

COLORS / FINISHES:

White matte and gloss finish as standard

Available in a range of blu·stone™ colors + finishes (special order)

ACCESSORIES (sold separately):

-Recommend QTW-0150, QTW-0121, or TW121 push button waste

INSTALLATION NOTES:

Install this product according to the installation guide.

Our products must be installed by certified professionals only and according to our installation guide as well as federal, provincial / state and local building codes and regulations.

Product has an overflow. Spout must provide a minimum of 5" reach for adequate clearance into basin.

CODES / STANDARDS APPLICABLE:

- ASME A112.19.2
- IAPMO / cUPC
- ICC / ANSI A117.1
- CSA B 45
- Fixture dimensions and hydraulic performance meet or exceed ANSI / ASME standard A112.19.2, A112.19.9M and CAN / CSA B 45 requirements.

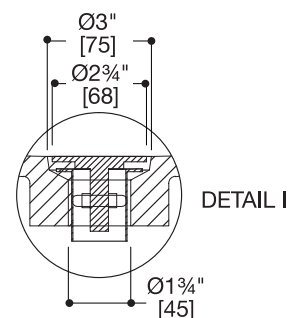
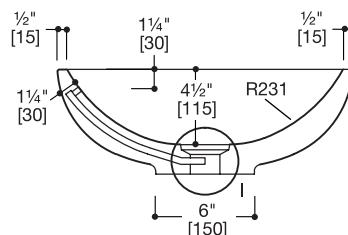
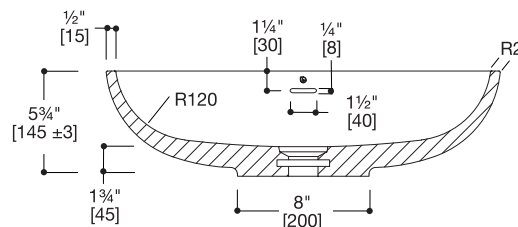
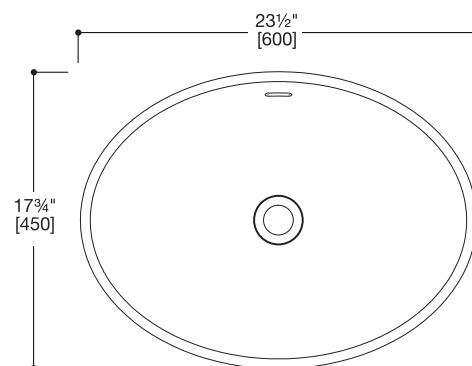

*Approximate measurements for comparison only.

Note: These dimensions and specifications are subject to change without notice.