



Product Specifications

Design Groves & Co.
Series SRG

*Towel Bar Length (A)

Length (A)	Code
12" (305mm)	SRG-820-12-HI51-SN
18" (457mm)	SRG-820-18-HI51-SN
24" (610mm)	SRG-820-24-HI51-SN

Primary Finish

SN Satin Nickel

Handle Finish

HI51 Dark Brown PVD

Applicable Codes & Standards

Specified model meets or exceeds the following:

- ASME A112.18.1
- NSF 61

Important

Dimensions are nominal and may vary within the range of tolerances established by ANSI Standard A112.18.1. These measurements are subject to change or cancellation. No responsibility is assumed for use of superseded or voided pages.

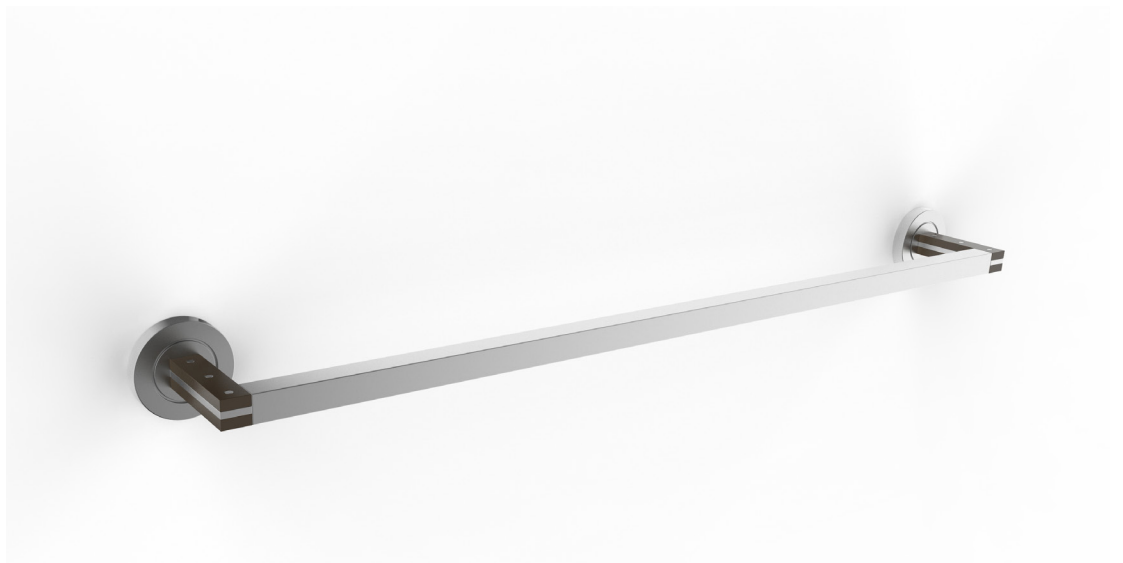
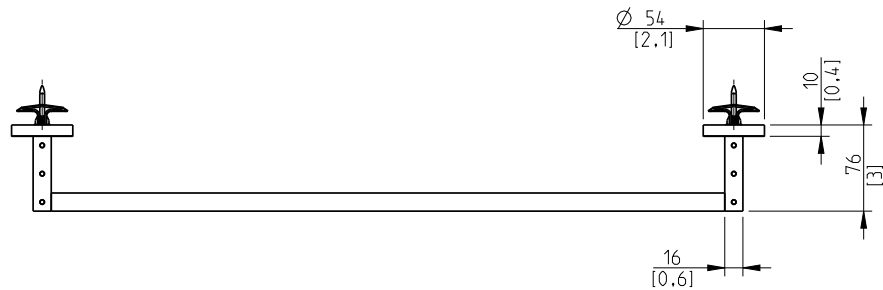
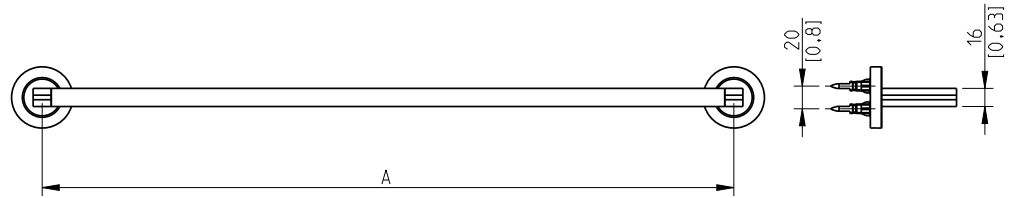

Dimensions mm [inches]