

D-Code Vessel Sink # 07065000082 / 07065000092

| < 19 5/8 " > |

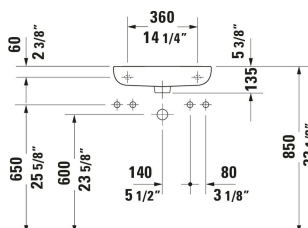
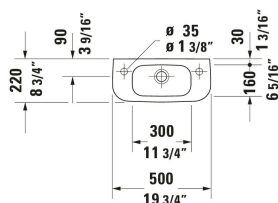

Vessel Sink	Dimension	Weight	Order number
Semi-circular, Includes faucet deck: Yes, Overflow: Yes, Underside glazed, Back side glazed: No, 19 5/8 ", cUPC listed: Yes			
Colors			
00 White			
Variant			
● White High Gloss, Rectangular, Number of basins: 1 Middle, Number of faucet holes: 1 Right, ADA: No		15.432 lb	07065000082
● White High Gloss, Rectangular, Number of basins: 1 Middle, Number of faucet holes: 1 Left, ADA: No		15.432 lb	07065000092
Infobox			
Mandatory in combination with a bottle trap			
Spare parts			
Sink Drain Suitable for washbasin with overflow, Ø 2 1/2 "	Ø 2 1/2 "	0.772 lb	005052

All drawings contain the necessary measurements which are subject to standard tolerances. They are stated in inch & mm and are non-binding. Exact measurements, in particular for customized installation scenarios, can only be taken from the finished ceramic piece.