



Product specifications

• 8-5/8" Projection

- Hand shower set: Standard spray
- Spout: Round aerated stream
- Hand shower set with anti-scale technology
- Integrated diverter
- Total height 5-1/4"
- Height to aerator/spout outlet 4-1/4"
- Valve hole diameter 1-1/4"
- Spout hole diameter 1-3/8"
- Hole diameter for hand shower set 1-1/4"
- Hand shower set with flange 2-1/8" x 2-1/8"
- Valve with flange 2-1/8" x 2-1/8"
- Metal shower hose 68-7/8" with anti-twist device
- Spout flow rate max. 5.2 gpm
- Handshower flow rate max. 2 gpm

Internal backflow preventer.

NOTE: Local building codes may require the use of an anti-scald device. Please refer to remote pressure balance valve (35 910 970 90)

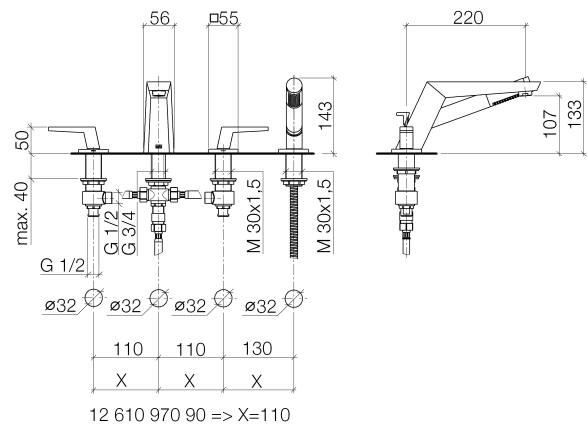

Surfaces

- | | |
|-------------|-------------|
| • chrome | 27532732-00 |
| • champagne | 27532732-47 |

Exploded assembly drawing

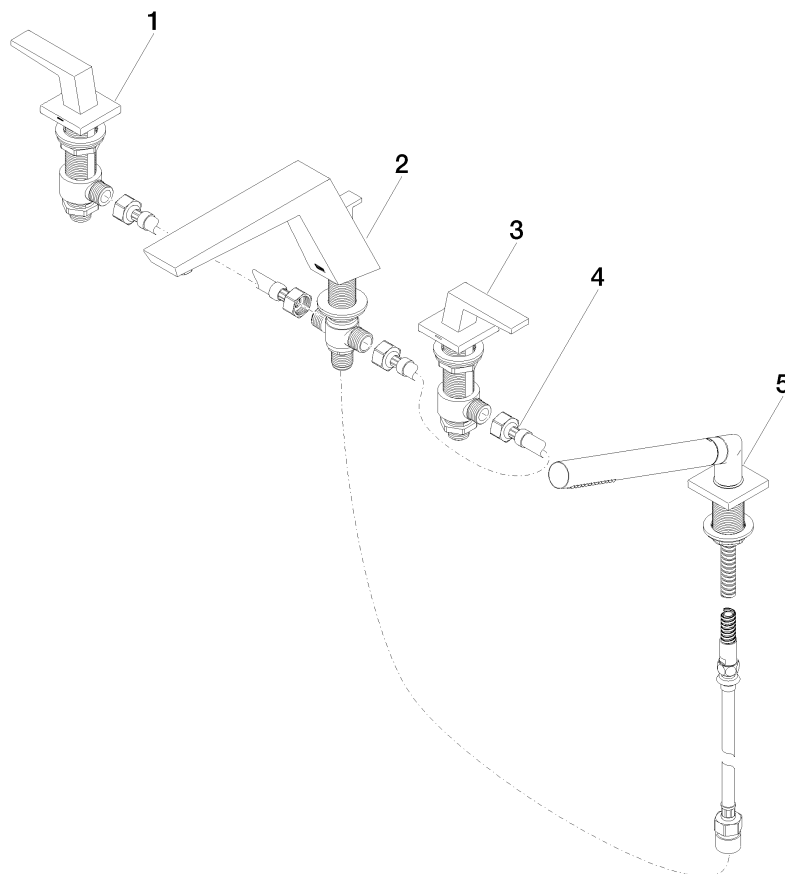

Order quantity

No.	Article number	Name	Installation quantity
1	20000732ff	side panel	1
2	13512730ff	spout	1
3	20000733ff	side panel	1
4	1250297090	hose	2
5	27708780ff	shower set	1

Flow rate chart

